

**KENDRIYA VIDYALAYA PICKET, SECUNDERABAD**

**HALF YEARLY EXAMS -2022-23**

Subject: Mathematics      Class-IV.....      Time: 2½ Hours  
Name.....      Roll No. ....      Date: .....

**GRADE SHEET**

Comp.	CONCEPT		Ability to Compute	P.S.A.	Total
	Knowledge	Understanding			
V.P.	20	20	20	20	80
V.P.O.					

Sign.Of. Invigilator.....

Sign. of Examiner.....

**Knowledge (20)**

**VSA**

**10 X 1 = 10**

Q.1) How many faces are there in a cuboid?

- (a) 6                      (b) 8                      (c) 9                      (d) 12

Q.2) How many sides are there in a rectangle?

- (a) 3                      (b) 5                      (c) 4                      (d) 6

Q.3) How many centimetres make 1 metre?

- (a) 100cm              (b) 10mm              (c) 10cm              (d) 1000cm

Q.4) Name the Indian currency.

- (a) Dollar              (b) Taka              (c) Pond              (d) Rupee

Q.5) Cost of one book is Rs. 10. Find the cost of five books?

- (a) Rs50              (b) Rs150              (c) Rs 100              (d) Rs 500

Q.6) How many days are there in a week?

- (a) 30                      (b) 10                      (c) 24                      (d) 7

Q.7) What is the product of 152 and 100 ?

- (a) 0                      (b) 1052                      (c) 15200                      (d) 1520

Q.8) Choose the smallest 4 digit number.

- (a) 3333                      (b) 9999                      (c) 100                      (d) 1000

Q.9) What is the sum of 1923 and 0 ?

- (a) 0                      (b) 1923                      (c) 19230                      (d) 19203

Q.10) What date will it be **6 days after** 30 January?

- (a) 6 February                      (b) 24 January                      (c) 5 February                      (d) 4 February

**S A**

**5X 2 = 10**

Q.11) Write the following numbers in digits.

Five thousand eight hundred eighty-two = \_\_\_\_\_

Eighty two thousand seven hundred thirty-three = \_\_\_\_\_

Q.12) Write the following dates in digits.

3<sup>rd</sup> July 2006 \_\_\_\_\_

15<sup>th</sup> August 1947 \_\_\_\_\_

Q.13) Write the following in am and pm.

7 o' clock in the morning = \_\_\_\_\_

10 minutes after 6 in the evening = \_\_\_\_\_

Q.14) How many hours are there between: -

(a) 6 am and 3 pm = \_\_\_\_\_

(b) 4 am and 11 am = \_\_\_\_\_

Q.15) Add to make these total 1 Litre.

(a) 400ml + \_\_\_\_\_ = 1 L

(b) 250 ml + \_\_\_\_\_ = 1 L

## Understanding (20)

VSA

6 X 1 = 6

Fill in the blanks from given box. (Q1 to Q6)

31	12	60	9999	20:30	40
----	----	----	------	-------	----

Q.1) There are \_\_\_\_\_ months in a year.

Q.2) There are \_\_\_\_\_ days in the December.

Q.3) The greatest 4 digit number is \_\_\_\_\_.

Q.4) There are \_\_\_\_\_ seconds in a minute.

Q.5) How long is your games period? \_\_\_\_\_ minutes.

Q.6) Time 8:30 in the evening = \_\_\_\_\_ hours.

SA

5X 2 = 10

Q.7) How long will it take the minute hand to move from-

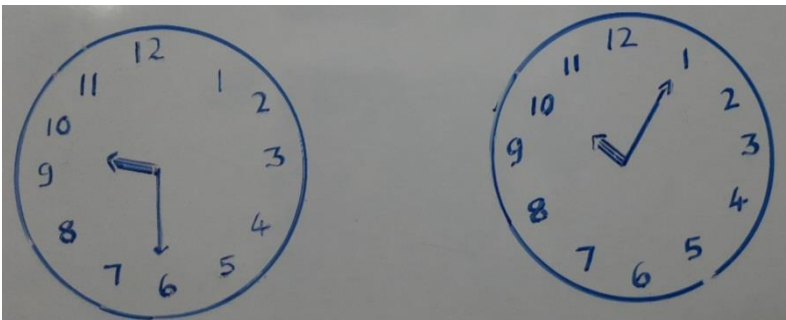

Starting time = \_\_\_\_\_

Ending time = \_\_\_\_\_

Duration = \_\_\_\_\_

Q.8) Match the following.

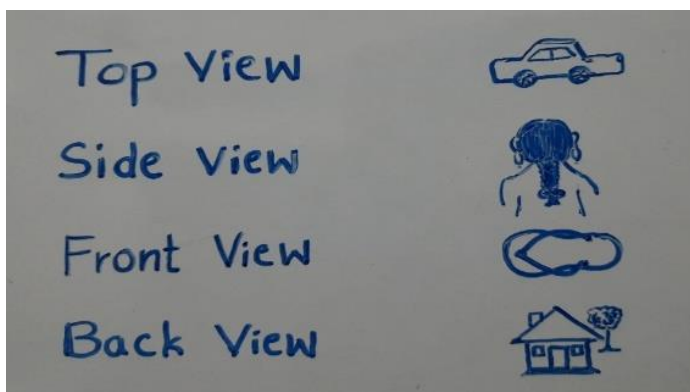

Q.9) Make the smallest and the largest 3-digit number using 9, 6 and 4.

Smallest number = \_\_\_\_\_

Largest number = \_\_\_\_\_

Q.10) Draw a line of the following lengths.

(a) 5 cm

(b) 4 cm

Q.11) Which things are measured in litre in your house?

(a) \_\_\_\_\_

(b) \_\_\_\_\_

LA

1x4=4

Q.12) Look at the map of the school given below and answer the following questions.

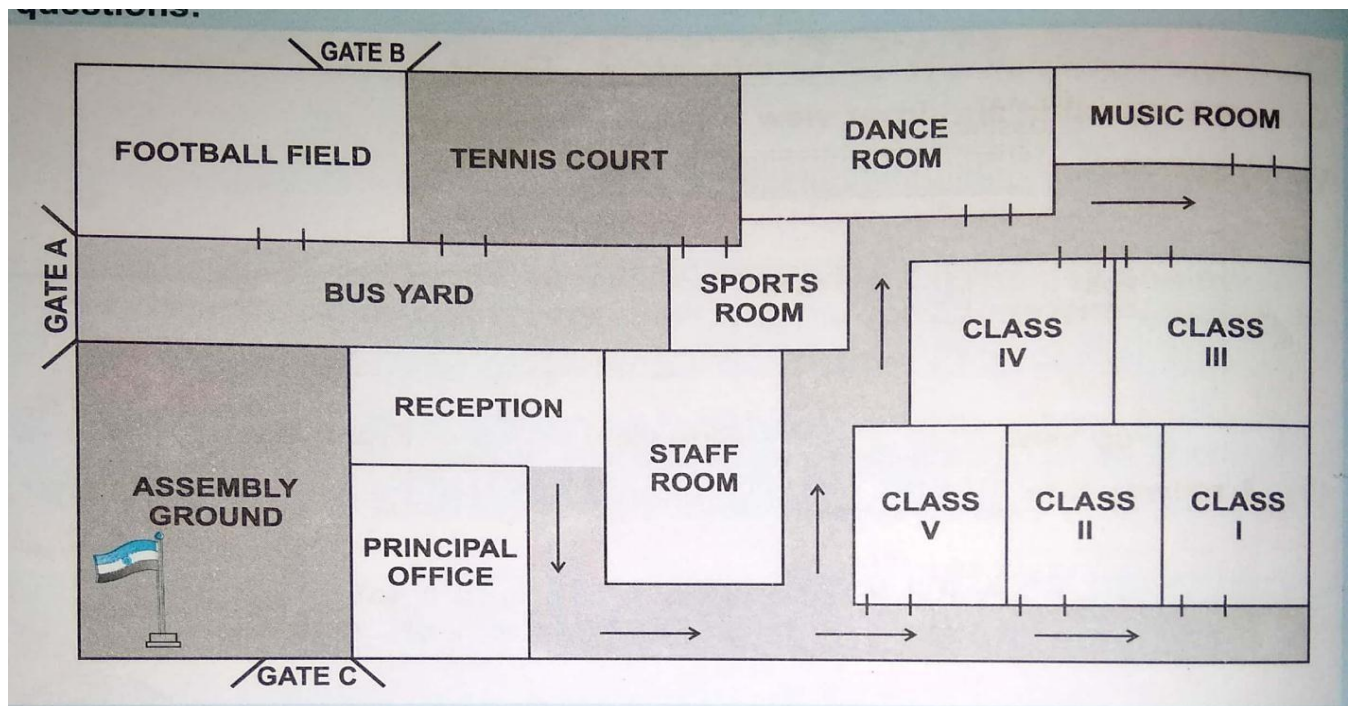

(a) Which class is between class V and class 1? \_\_\_\_\_

(b) Which is to the right of the football field? \_\_\_\_\_

(c) Which room is to the left of class III? \_\_\_\_\_

(d) When you enter from Gate C, the classrooms will be on your left hand side (or) right hand side? \_\_\_\_\_

## ABILITY TO COMPUTE (20)

**VSA**

$$6 \times 1 = 6$$

Q.1) Solve the following sum:-

$$105 + 125 = \underline{\hspace{2cm}}$$

Q.2)  $2 \times 175 =$  \_\_\_\_\_

Q.3) 20 x 100 ml = \_\_\_\_\_ ml = \_\_\_\_\_ L

Q.4) 6 notes of Rupees 100 = Rs\_\_\_\_\_

Q.5) 7m 10cm = \_\_\_\_\_ cm

Q.6) Days of January + February = \_\_\_\_\_days

**SA**

$$5X \ 2 = 10$$

Q.7) Find the sum:

58 rupees 65 paise

+ 25 rupees      20 paise

---

Q.8) Add:-

4 4 0 6

$$+ \quad 1 \ 0 \ 4 \ 5$$

$$+ \quad 9 \quad 8 \quad 1$$

---

Q.9)

5 8 5

X 4

---

Q.10) Find the difference:

8 L 350 mL

3 L 200 mL

---

Q.11) Find the sum:

7 m 35 cm

– 2 m 20 cm

\_\_\_\_\_

LA

$$1 \times 4 = 4$$

Q.12 Find out the following using box method.

$$726 \times 35 = \underline{\hspace{2cm}}$$

X			

### **PROBLEM SOLVING ABILITY (20)**

**VSA**

**6 X 1 = 6**

Q.1) One mini bus can carry 20 children. How many children can be carried by 10 such buses?

- (a) 40                      (b) 60                      (c) 80                      (d) 200

Q.2) A hockey match started at 4:00 p.m. and ended at 6:00 p.m. How long did the match last?

- (a) 5 Hrs                      (b) 2 Hrs                      (c) 4 Hrs                      (d) 7 Hrs

Q.3) Kiran bought 1 kg plastic for Rs. 25, but sold 1 kg plastic for Rs 30. How much money does she earn on selling 1 kg plastic?

- (a) Rs 6                      (b) Rs 4                      (c) Rs 2                      (d) Rs 3

Q.4) How many 200 ml bottles can be filled from a 2 litre container?

- (a) 6                      (b) 10                      (c) 20                      (d) 8

Q.5) Calculate the total amount of money.

6 ten rupee notes and 3 five rupee notes = Rs\_\_\_\_\_

Q.6) Adding 5 paise hundred times we get Rs \_\_\_\_\_

**S A**

**5X 2 = 10**

**Solve the following questions.**

Q.7) Sita had Rs 4500 in her bank. She deposited Rs 2000 more. How much money does she have in her bank account?

Q.8) Rajesh bought 3 ice creams for Rs 20, Rs 32 and Rs 40. How much money did he pay?

Q.9) Manisha walks around the rectangular park. If she covers 500m in one round. How much distance does she cover in 6 rounds?

Q.10) Ravali makes one roti in 3 minutes, how much time does she take to make 123 roties?

Q.11) Amina water bottle holds 750 ml of water. She drank 150 ml of water. How much water is left in her bottle?

LA

1 x4 = 4

Q.12. Look at the attendance Record given below and give answers.

14.08.2022 Class	Total number of students	Number of students absent	Number of Students Present
Class I	46	2	44
Class II	40	4	36
Class III	48	Nil	_____
Class IV	40	2	38
Class V	42	Nil	_____
Total	_____	_____	_____

**Answer these: ---**

- (a) Total number of students in the school? \_\_\_\_\_
- (b) Total number of students absent in the school? \_\_\_\_\_
- (c) Total number of students present in the school? \_\_\_\_\_
- (d) Which class strength is nearer to 50 ? \_\_\_\_\_

---

xxx